



## Jennie's Meadow

### The JEFFERSON

*Choose peace of mind in your new single-family home, built with care and quality—including professional lawn and landscaping maintenance.*

With a gracious 2,053 square feet, it's the largest floor plan at Jennie's Meadow, with two bedrooms, a den and a formal dining room plus breakfast nook. Both the central gathering room and the laundry room are larger in the Jefferson plan.

**Open floor plan:** Homes feature a great room with fireplace and entertainment area, combined with a spacious kitchen and light-filled nook adjoining a covered outdoor patio. Oversized doors and windows add space and natural light. Architectural details like half-columns serve to define room transitions.

**Luxurious master suite:** A hallway entry adds privacy; there's access to a covered porch, a spacious walk-in closet, two vanity sinks, showers with built-in seats and private commodes.

**Guest suites:** The second bedroom has its own bath, ensuring privacy for you and your guests or family.

**Maximum attention to detail:** Walls have rounded corners; trim and molding are white painted enamel; hardware matches throughout the home.

**More features:** Fully-landscaped yards with irrigation; stylish and efficient kitchen islands with tiled counters; a separate laundry room with cabinetry; centralized media panel (with Cat-5 wiring); energy efficient heat pumps; and a two-car, attached garage. The expansive rear patio and covered porches in the front and back of your Westerra Home invite you to enjoy Sequim's wonderful weather all year long.

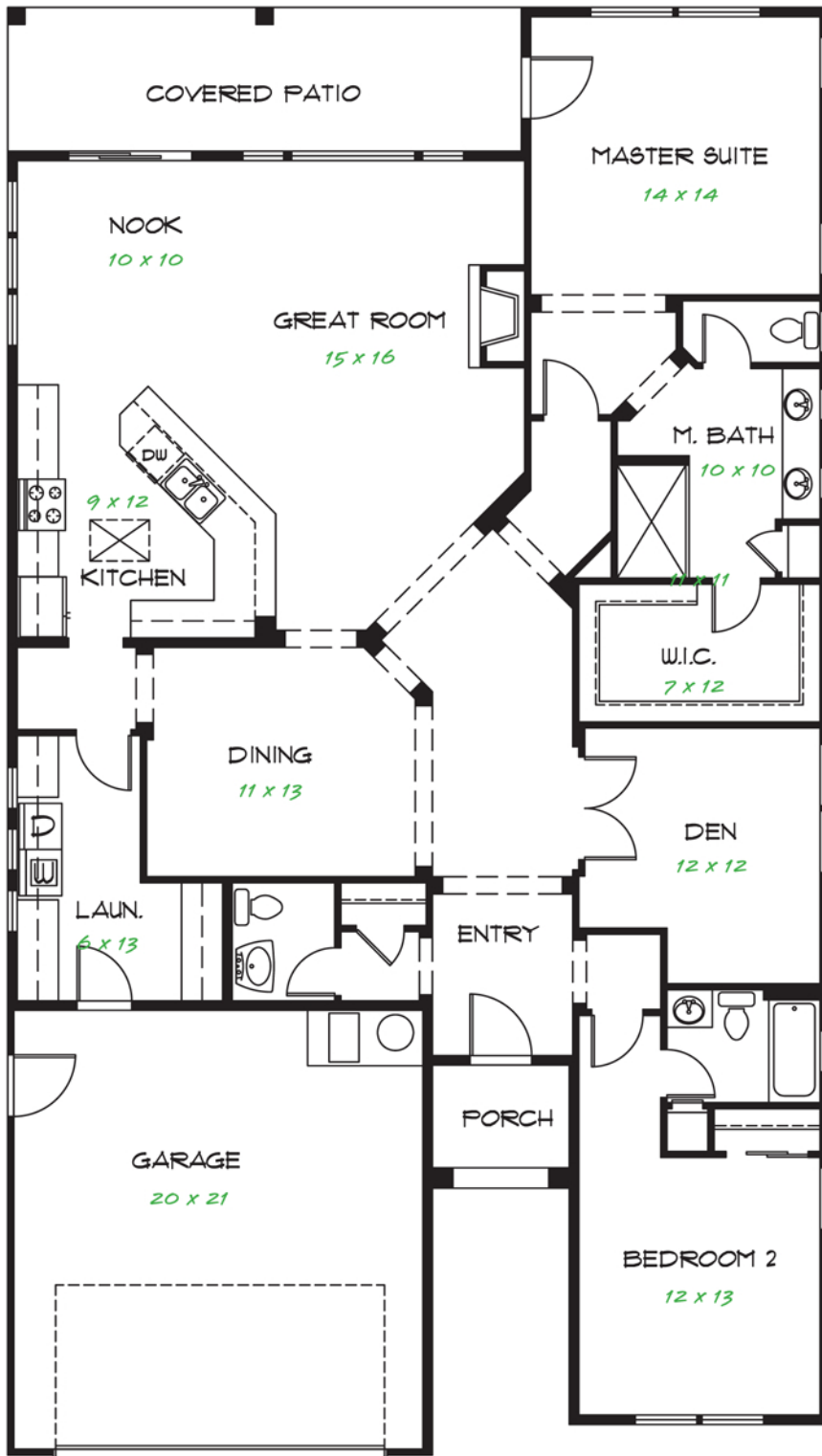

**Two architectural styles:** Choose exterior details and trim to create a traditional, Classic feel or select the solid Craftsman look. Both feature clapboard siding with shingled accents, and a selection of gentle, earth-tone paint colors. See elevation styles, over.

**Westerra**HOMES  
YOUR DREAM HOME BUILDER

WE BUILD ON YOUR LOT. CALL WESTERRA HOMES (360) 509-0633



## The JEFFERSON

**Two architectural styles:** Choose exterior details and trim to create a traditional, Classic feel or select the solid Craftsman look. Both feature clapboard siding with shingled accents, and a selection of gentle, earth-tone paint colors.

### The Craftsman



### The Classic



WE BUILD ON YOUR LOT. CALL WESTERRA HOMES (360) 509-0633